

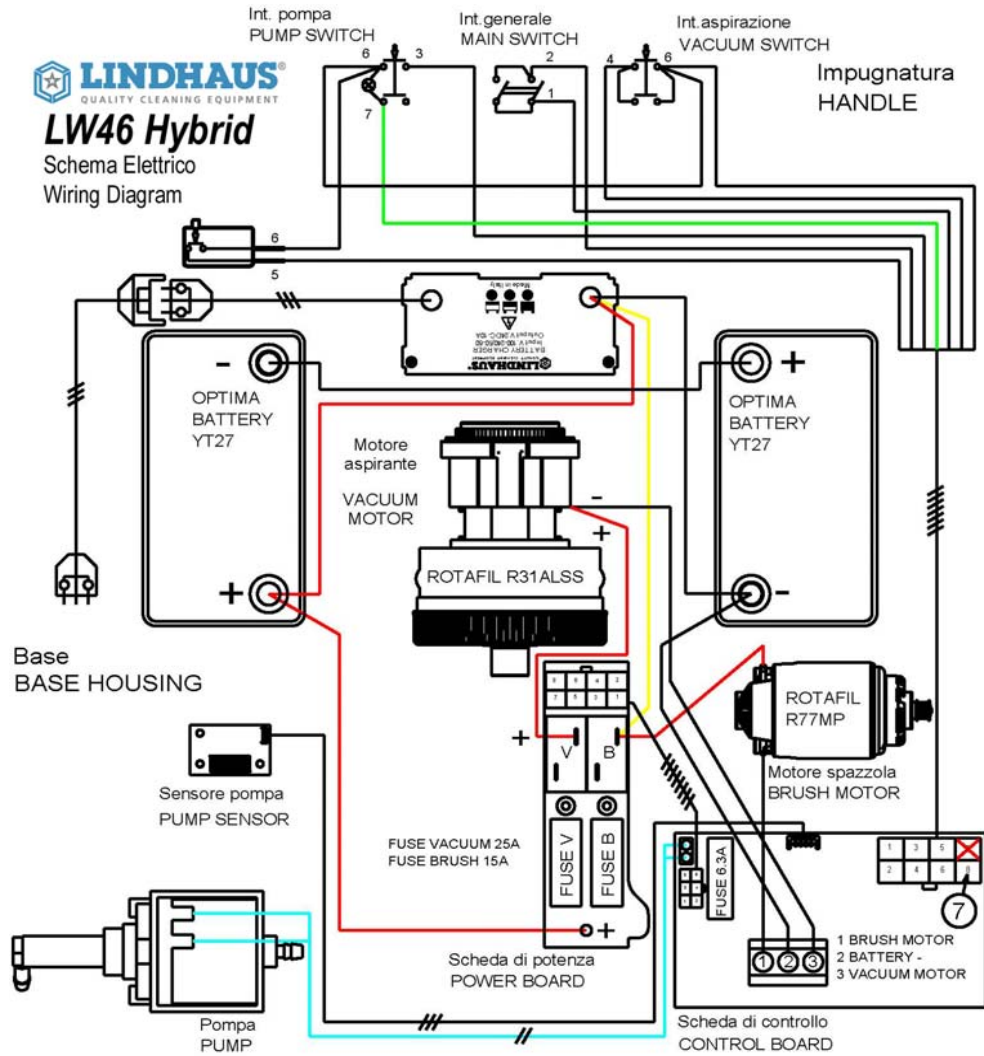

LW46 Hybrid

Schema Elettrico
Wiring Diagram



NOTE

LW 46 Hybrid

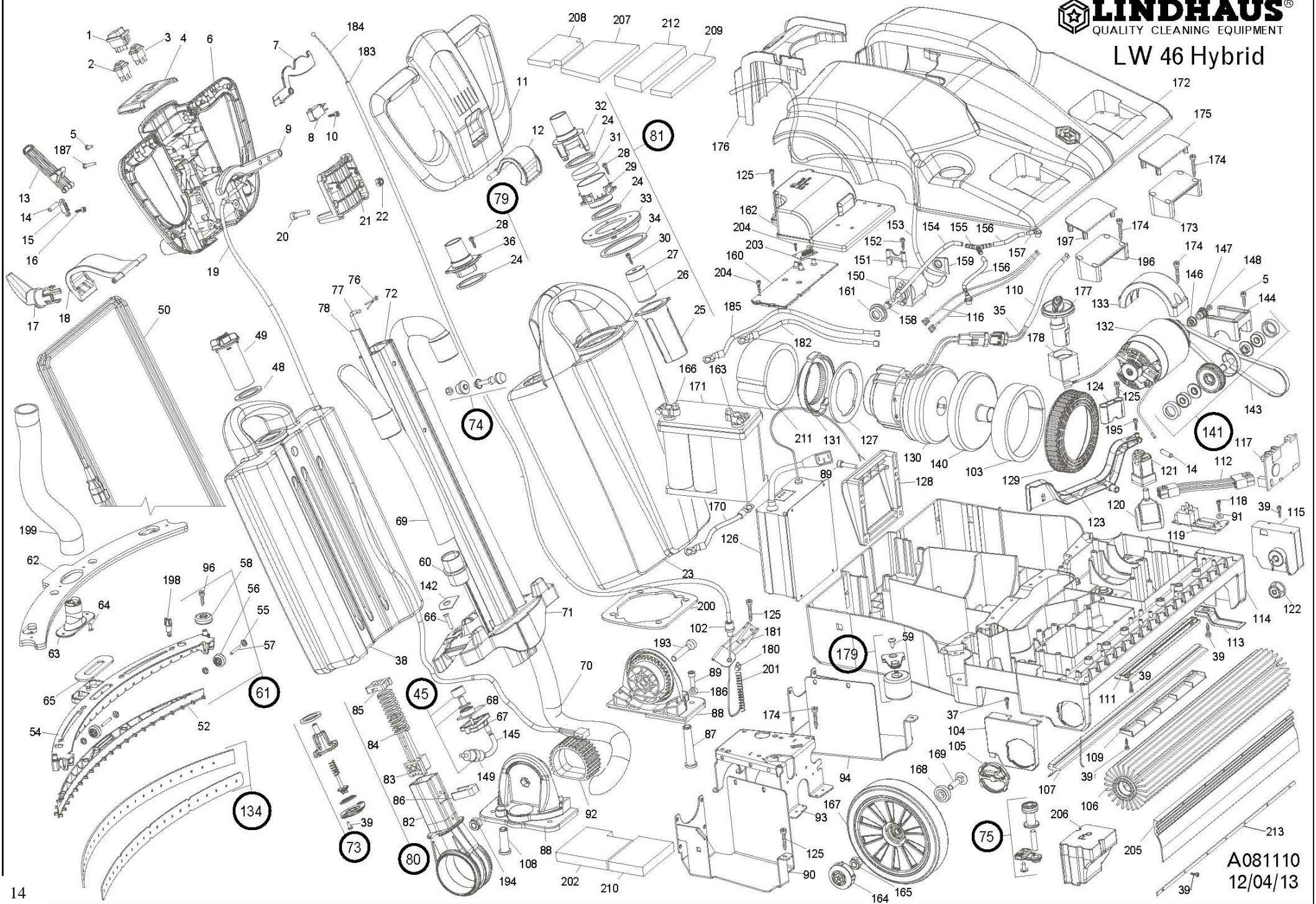

A081110
12/04/13

SPARE PARTS LIST - LISTA PARTI DI RICAMBIO - LISTE DER ERSATZTEILE
LISTE PIÈCES DE RECHANGE - LISTA PIEZAS DE RECAMBIO
LW 46 Hybrid
High tech scrubber

Part.	DESCRIPTION	Part.	DESCRIPTION	Part.	DESCRIPTION	Part.	DESCRIPTION
LH 1	Switch main	LH 57	Shaft squeegee wheels (20pcs)	LH 106	Brush roller LW46	LH 159	Gasket pump
LH 2	Switch pump	LH 58	Wheel side squeegee (20pcs)	LH 107	Extruded sweep rubber	LH 160	Support water sensor
LH 3	Switch vacuum	LH 59	Screws 4,8x13 TG (20pcs)	LH 108	Strain relief D. 6	LH 161	Pump gasket
LH 4	Switches plate	LH 60	Connector hoses	LH 109	Water distribution channel	LH 162	Cover motor-c. boards
LH 5	Screws 3,9x25 B. (20pcs)	LH 61	Support squeegee kit	LH 110	Wires protection tube	LH 163	Battery pole -
LH 6	Handle rear	LH 62	Steel support squeegee	LH 111	Holed distribution channel	LH 164	Cover rear wheels (2pcs)
LH 7	Lever switch brush motor	LH 63	Tube inlet squeegee	LH 112	Boards connection wires	LH 165	Nut M10 AB (20pcs)
LH 8	Microswitch brush motor	LH 64	Screws M4x6 TS (20pcs.)	LH 113	Cover transmission	LH 166	Battery pole +
LH 9	Joint lever	LH 65	Gasket inlet squeegee	LH 114	Base LW46	LH 167	Rear wheel D.200
LH 10	Screws 2,9x19 (20 pcs.)	LH 66	Screw 3,9x13 TS (20pcs.)	LH 115	Transmission support epl.	LH 168	Spacer rear wheel (20pcs)
LH 11	Handle front	LH 67	Body valve	LH 116	Pump wires kit (2pcs)	LH 169	Screw wheel M10x45 (20pcs)
LH 12	Hook front tank	LH 68	Gasket valve	LH 117	Circuit control board	LH 170	Battery – battery cable
LH 13	Lever base lifting	LH 69	Hose recovery L. 700mm	LH 118	Screw 3,9x22 (20pcs.)	LH 171	Optima battery YT27 AGM
LH 14	Axle lifting Lever (20 pcs)	LH 70	Hose suction L.1350mm	LH 119	Fuses circuit board	LH 172	Base cover
LH 15	Cord clamp	LH 71	Support tanks	LH 120	Central wheel	LH 173	Front handle right
LH 16	Screws 2,9x16 (20pcs)	LH 72	Wand aluminium	LH 121	Support central wheel	LH 174	Screw 4,8x50 (20 pcs)
LH 17	Cord hook	LH 73	Gasket water tank	LH 123	Lever central wheel	LH 175	Cover front handle right
LH 18	Hook rear tank	LH 74	Tanks guide kit	LH 124	Bridge lever	LH 176	Cover battery charger
LH 19	Cord 7 wires	LH 75	Kit squeegee rollers (5pcs.)	LH 125	Screw 4,8x22 (20pcs.)	LH 177	Adjusting knob
LH 20	Screws M6x25 (20pcs)	LH 76	Block pin (20pcs.)	LH 126	Charger battery	LH 178	Regulator
LH 21	Handle bridge	LH 77	Bar release joint	LH 127	Gasket vac. Motor adhesive	LH 179	Side wheels kit (6pcs)
LH 22	Nut M6 (20 pcs)	LH 78	Extruded wand cover	LH 128	Handle rear	LH 180	Cord block
LH 23	Recovery tank	LH 79	Tube tank entrance kit	LH 129	Gasket suction group	LH 181	Support plate
LH 24	Gasket tube connector	LH 80	Joint LW46 kit	LH 130	Vac motor Rotafil R31ALSS	LH 182	Battery – board cable Black
LH 25	Float housing	LH 81	Float housing tube kit	LH 131	Gasket fan cover	LH 183	Cord protection guide
LH 26	Float long	LH 82	Joint	LH 132	Brush motor Rotafil MP77	LH 184	Flex steel cord
LH 27	Float short	LH 83	Block joint	LH 133	Bridge brush motor	LH 185	Battery – board cable RED
LH28	Screws 5x16 HL (20pcs)	LH 84	Spring joint	LH 134	Kit squeegee	LH 186	Washers 6x20 (20pcs)
LH 29	Housing motor prot. filter	LH 85	Guide spring	LH 140	Conveyor vac motor	LH 187	Screw 3,9x32 (20 pcs)
LH 30	Screws 3,5x32 IX (20pcs)	LH 86	Plate block spring	LH 141	Double pulley kit	LH 193	Screw M8x50 (20pcs)
LH 31	Filter motor protection	LH 87	Strain relief D. 8	LH 142	Gasket tanks support	LH 194	Nut M8 AB (20pcs)
LH 32	Float housing tube	LH 88	Support joint kit (2pcs)	LH 143	Timing belt	LH 195	Screw 3,9x9,5 (20pcs)
LH 33	Cup recovery tank	LH 89	Screw M6x20 (20pcs)	LH 144	Bridge double transm.	LH 196	Front handle left
LH 34	Gasket float cup	LH 90	Mounting plate left	LH 145	Water tube L. 60mm	LH 197	Cover front handle left
LH 35	Wires + conn. Vac mtr.	LH 91	Washer D.12 - F.4 (20pcs)	LH 146	Spacer pinion	LH 198	Clip squeegee (20pcs)
LH 36	Tube tank entrance	LH 92	Metal teeth insert	LH 147	Pinion	LH 199	Hose squeegee
LH 37	Screws 3,5x13 IX (20pcs)	LH 93	Mounting central plate	LH 148	Nut M4 (20pcs)	LH 200	Joint gasket
LH 38	Water tank	LH 94	Mounting right plate	LH 149	Filter pump (10pcs.)	LH 201	Spring base lifting
LH 39	Screws 3,5x16 IX (20pcs)	LH 96	Screw 4,8x9,5 TG (20pcs.)	LH 150	Pump 24VAC	LH 202	Sound insulation
LH 45	Filter pump kit (3pcs.)	LH 102	Antiwear cord guide	LH 151	Bridge pump	LH 203	Water sensor
LH 48	Gasket dosing cup	LH 103	Filter vacuum motor	LH 152	Screws 3,9x45 (20pcs)	LH 204	Screw 3,9x13 (20pcs)
LH 49	Dosing cup	LH 104	Support side me tal	LH 153	Water tube L. 1000mm	LH 205	Front bumper (optional)
LH 50	Cable 15 mt with plugs	LH 105	Brush support kit	LH 154	Water tube L.305mm	LH 206	Ballast PB
LH 52	Squeegee support			LH 155	Y connector	LH 207	Filter exhaust cooling air
LH 54	Housing squeegee			LH 156	Water tube L.105mm	LH 208	Filter intake cooling air
LH 55	Spring washers (20 pcs.)			LH 157	90° connector + insert	LH 209	Filter exhaust suction air
LH 56	Rubber wheels D.22 (20pcs)			LH 158	90° connector	LH 210	Sound insulation
						LH 211	Motor filter
						LH 212	Foam filter base

WARNING

Use only the brushes provided with the appliance or those specified in the instruction manual. The use of other brushes may impair safety.

ATTENZIONE

Usare solo le spazzole fornite con l'apparecchio o quelle specificate nel manuale istruzioni. L'uso di altre spazzole può compromettere la sicurezza.

ACHTUNG

Verwenden Sie nur die Pinsel, die mit dem Gerät oder in der Bedienungsanleitung angegeben ist gekommen. Die Verwendung von anderen Bürsten kann die Sicherheit gefährden.

ATTENTION

N'utiliser que des balais qui viennent avec l'appareil ou dans le manuel d'instruction. L'utilisation de brosses d'autres peuvent compromettre la sécurité.

ATENCIÓN

Sólo utilizar los pinceles que vienen con el dispositivo o se especifica en el manual de instrucciones. El uso de otros cepillos puede comprometer la seguridad.



Red brush roller **INTERMEDIATE** (standard)
 Rullo rosso **INTERMEDIO** (standard)
 MITTLERE rote Rolle (standard)
 Rouleau rouge **INTERMEDIAIRE** (standard)
 Rodillo rojo **INTERMEDIO** (standard)



- Lindhaus offers alternative brush and abrasive padded rollers to help removing any type of soils from the floors (optional)
 - Lindhaus offre rulli alternativi in setola o dotati di pad abrasivi per aiutare a rimuovere ogni tipo di sporco dal pavimento (optional)
 - Lindhaus bietet alternative Borstenrollen und Rollen mit Scheuereinlagen an um jede Art von Schmutz vom Boden zu entfernen. (freigestellt)
 - Lindhaus offre des brosses alternatives en soies ou pads abrasifs pour aider à enlever la saleté de tous types sols (option)
 - Lindhaus ofrece cepillos alternativos de cerdas o pad abrasivos que ayudan a eliminar la suciedad de cualquier tipo de suelo (opción)